

DKDP POCKELS CELL

[custom design upon request]

Standard Models

Model Code	Clear Aperture	Size (mm)
IMA8a	Ø8 mm	Ø19×24
IMA8b	Ø8 mm	Ø19×24.7
IMA10a	Ø10 mm	Ø25.4×32
*IMA10Pa	Ø10 mm	Ø25.4×39
*IMA11Pa	Ø11 mm	Ø28×33
IMA13a	Ø13 mm	Ø25.3×42.5

*P Series: with additional parallel adjustment.

Technical Data

Clear Aperture (mm)	8	10	12	13
Single Pass Insertion Loss	< 2% @1064 nm			
Intrinsic Contrast Ratio	> 5000:1 @1064 nm			
Voltage Contrast Ratio	> 2000:1 @1064 nm			
Wavefront Distortion	< $\lambda/6$ @ 633 nm			
DC Capacitance (pF)	< 4.5	< 5.0	< 5.5	< 8.0
DC Quarter Wave Voltage	3200 +/- 200 V @1064 nm			
Single Pass Transmission	> 98.5%			
Laser Damage Threshold	750 MW/cm ² AR coatings @1064nm,10 ns,10Hz			

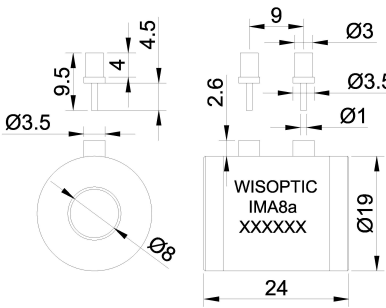

IMA8a

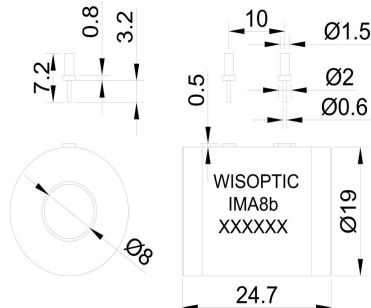

IMA8b

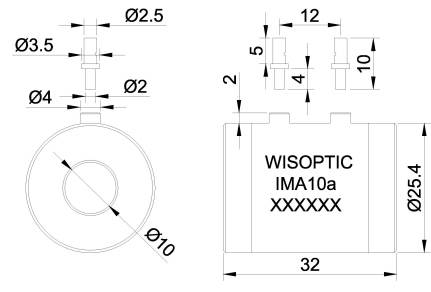

IMA10a

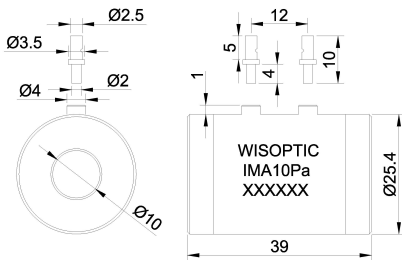

IMA10Pa

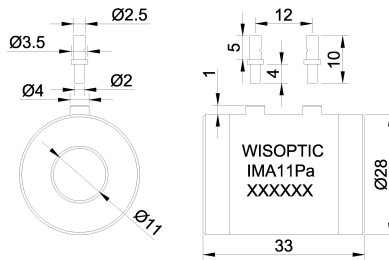

IMA11Pa

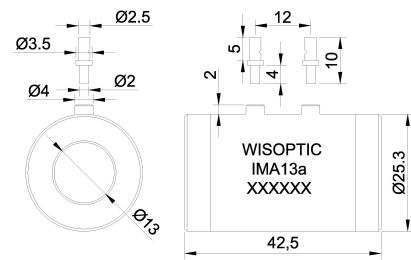

IMA13a

WISOPTIC TECHNOLOGY

13 Huaxianchang Road, Jinan 250100, P.R.China
sales@wisoptic.com Tel. +86-531-8801 4525 Fax. +86-531-8898 1531

INTEGRATED DKDP POCKELS CELL (i-series)

[with polarizer and wave plate inside]

Technical Data

Model Code	IMA-i8
External Dimension	Dia. 30 (+0, -0.1)×60 (+0.3, -0.3) mm
Clear Aperture	Φ8 mm
Intrinsic Contrast Ratio	> 500:1 @1064 nm
Wavefront Distortion	< $\lambda/6$ @ 633 nm
DC Capacitance	< 4.5 pF
DC Quarter Wave Voltage	3200 +/- 200 V @1064 nm
Single Pass Transmission	> 96%
Laser Damage Thershold	500 MW/cm ² AR coatings @ 1064nm, 10 ns,10Hz

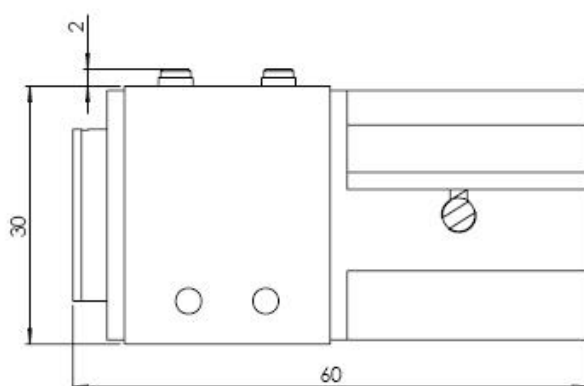

BBO POCKELS CELL

[custom design upon request]

Technical Data

Clear Aperture Diameter (mm)	2.5		3.5		4.5		5.5		6.5	
Crystal Size (mm)	3x3x20	3x3x25	4x4x20	4x4x25	5x5x20	5x5x25	6x6x20	6x6x25	7x7x20	7x7x25
Quarter-wave Voltage (kV) (@1064 nm, DC)	3.5	2.8	4.9	3.9	5.9	4.7	7.3	5.8	8.0	6.45
Capacitance	< 3 pF									
Optical Transmission	> 98%									
Contrast Ratio	> 1:1000 (30 dB)									
Cell size (mm) (Dia x Length)	25.4x35	25.4x40	25.4x35	25.4x40	25.4x35	25.4x40	25.4x35	25.4x40	30.0x35	30.0x40
Damage Threshold	750 MW/cm ² (1064 nm, 10 ns, 10 Hz)									

KTP POCKELS CELL

[custom design upon request]

Technical Data

Sizes of one of the pair of KTP (mm)	X-cut		Y-cut		Electrical Resistivity (Ohm·cm)
	HWV @1064nm (V)	Extinction Ratio @ 633nm (dB)	HWV @1064nm (V)	Extinction Ratio @ 633nm (dB)	
3×3×10	1200	> 20	1000	> 20	> 10 ¹¹
4×4×10	1600	> 20	1300	> 20	> 10 ¹¹
5×5×10	2000	> 20	1600	> 20	> 10 ¹¹
6×6×10	2300	> 20	1900	> 20	> 10 ¹¹
7×7×10	2700	> 20	2200	> 20	> 10 ¹¹
8×8×10	3100	> 20	2500	> 20	> 10 ¹¹
9×9×10	3500	> 20	2800	> 20	> 10 ¹¹
Damage Threshold: > 600MW/cm ² for 10 ns pulses @ 1064 nm (AR coating)					

KTP Q-switch working at 100kHz

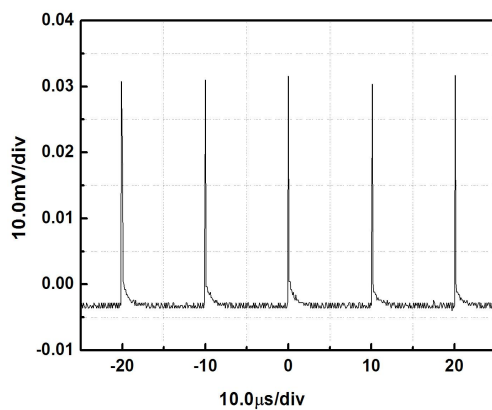

RTP POCKELS CELL

[custom design upon request]

Typical Performance Data of RTP Pockels Cell

Crystal size (mm)	4x4x10	6x6x10	8x8x10
Quantity of Crystals	2	2	2
Static Half-wave Voltage @ 1064 nm	X-cut: 1700 V Y-cut: 1400 V	X-cut: 2500 V Y-cut: 2100 V	X-cut: 3300 V Y-cut: 2750 V
Extinction Ratio	X-cut: > 25 dB Y-cut: > 23 dB	X-cut: > 23 dB Y-cut: > 21 dB	X-cut: > 21 dB Y-cut: > 20 dB
Capacitance	5~6 pF		
Optical Transmission	> 99%		
Damage Threshold	>600 MW/cm ² for 10 ns pulses @ 1064 nm (AR coating)		